

1

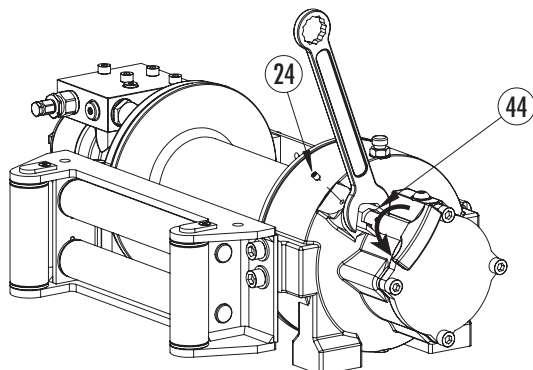

MANUAL CLUTCH DISASSEMBLING

Loosen and remove cap screw M6x10 (Ref.24) on the Gear Housing. Loosen and remove the Manual clutch by by loosening item (Ref. 44 see Pict.1 and Pict.2).

2

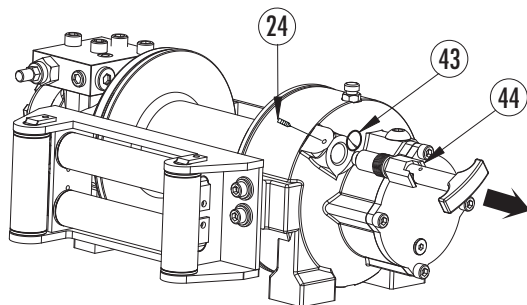

AIR CLUTCH SHIFTER MOUNTING

Procede to the air clutch mounting (Ref.44A) as shown to (Pict.3).

⚠ ATTENTION O-ring (Ref.43) has been shown separated from air clutch (Ref.44A), while effectively must be fitted onto the air clutch (Ref.44A) before air clutch being mounted onto the winch.

3

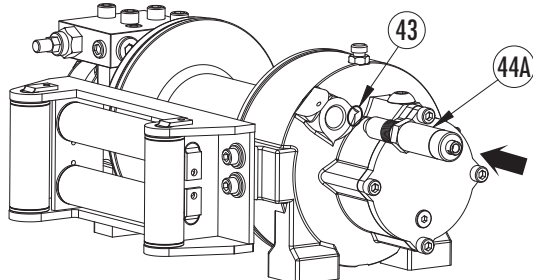

4

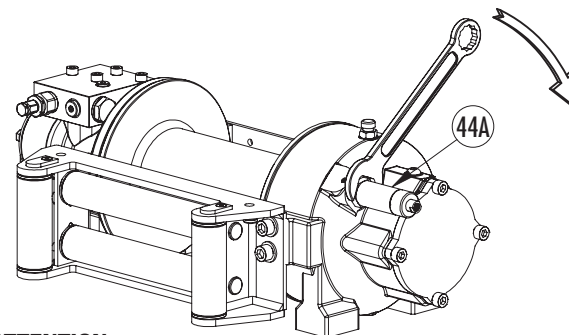

ATTENTION

Tighten the air clutch (Ref.44A) from the hexagon side, as shown at (Pict.4).

Never utilize pincers for its tightening as shown at (Pict.4). Air clutch body could be damaged.

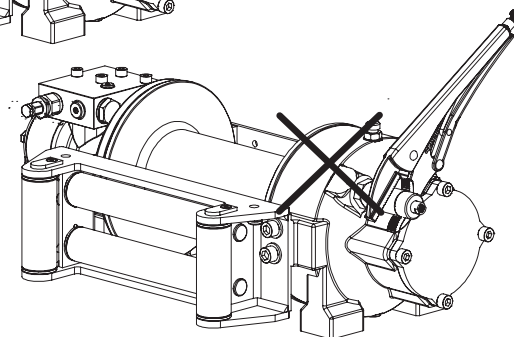

AIR CLUTCH SHIFTER MOUNTING

Tighten the air clutch (Ref.44A) as shown at (Pict.4) having care do not causing an excessive O-ring (Ref.43) flattening on gear housing, as shown at (Pict.5 view B).

5

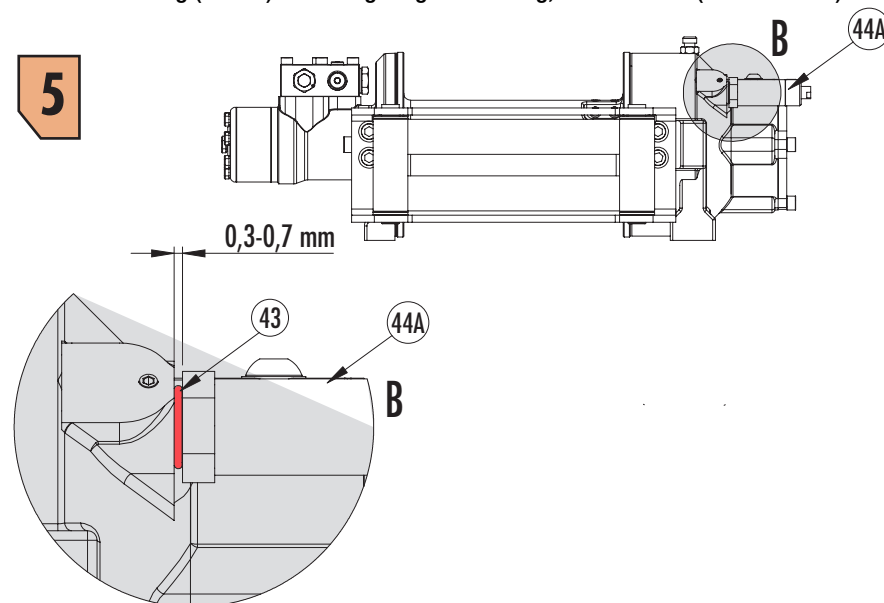

6

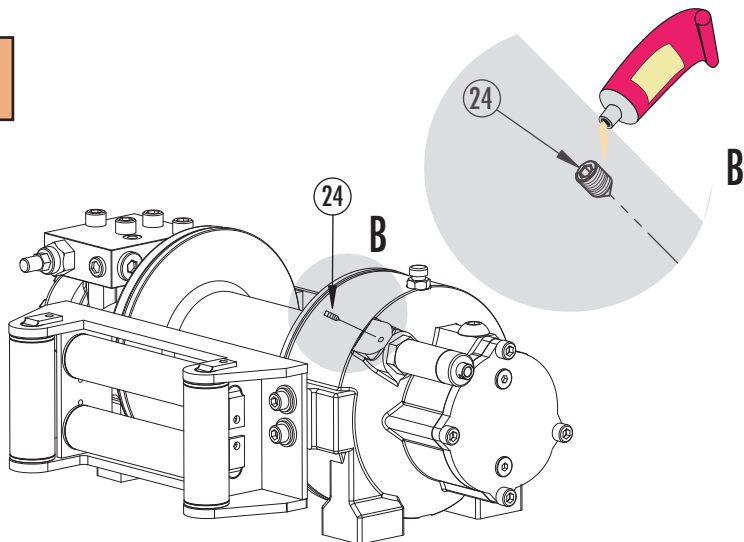

CAPSCREW TIGHTENING

Before to procede to the capscREW tightening (Ref.24) sprinkle the capscREW thread with a sealing product as shown (Pict.6 view B).

7

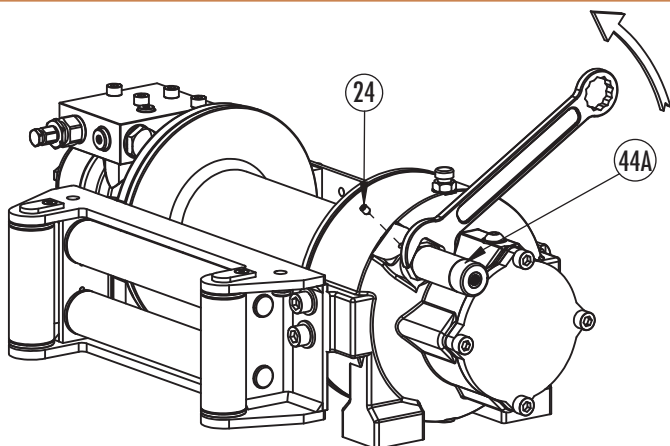

AIR CLUTCH DISASSEMBLING

Loosen and remove capscREW M6x10 (Ref.24) on the gear housing. Loosen and remove the air clutch loosening item (Ref. 44A see Pict.7).

8

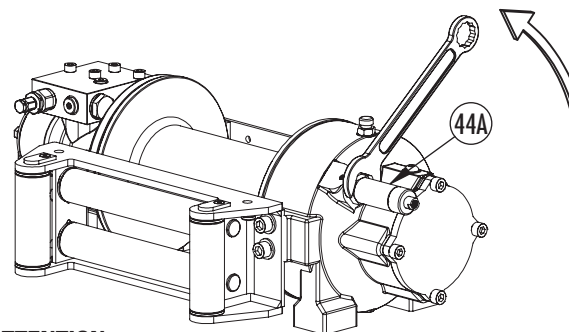

ATTENTION

Loosen the air clutch (Ref.44A) from the hexagon side, as shown at (Pict.7-8).
Never utilize pincers for its tightening as shown at (Pict.8).
Air clutch body could be damaged.

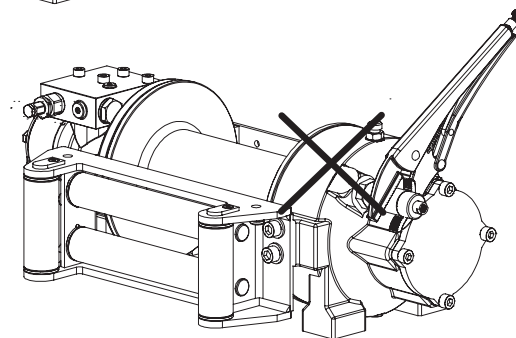

9

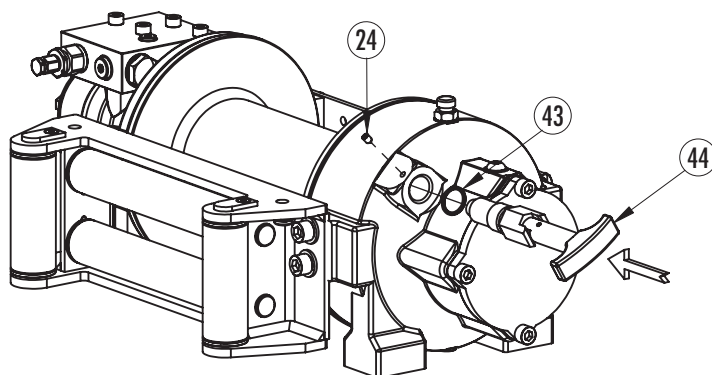

MANUAL CLUTCH ASSEMBLING

Proceed to the manual clutch mounting (Ref.44) as shown at (Pict.9).



ATTENTION O-ring (Ref.43) has been shown separated from manual clutch (Ref.44), while effectively must be fitted onto the manual clutch (Ref.44) before manual clutch being mounted onto the winch.

10

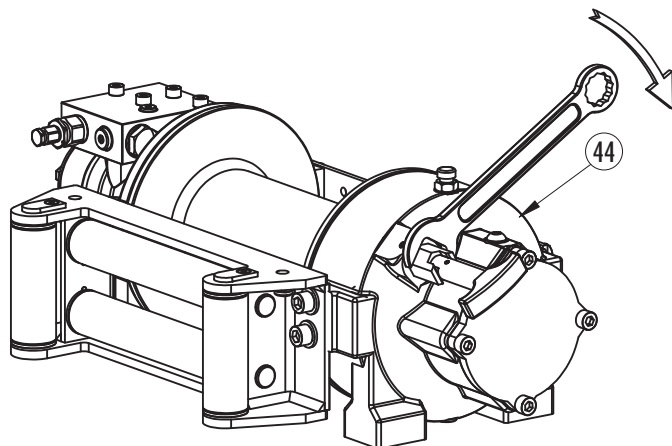

TIGHTENING

Proceed to the manual clutch tightening (Ref.44) from the hexagon side, as shown at (Pict.10).

11

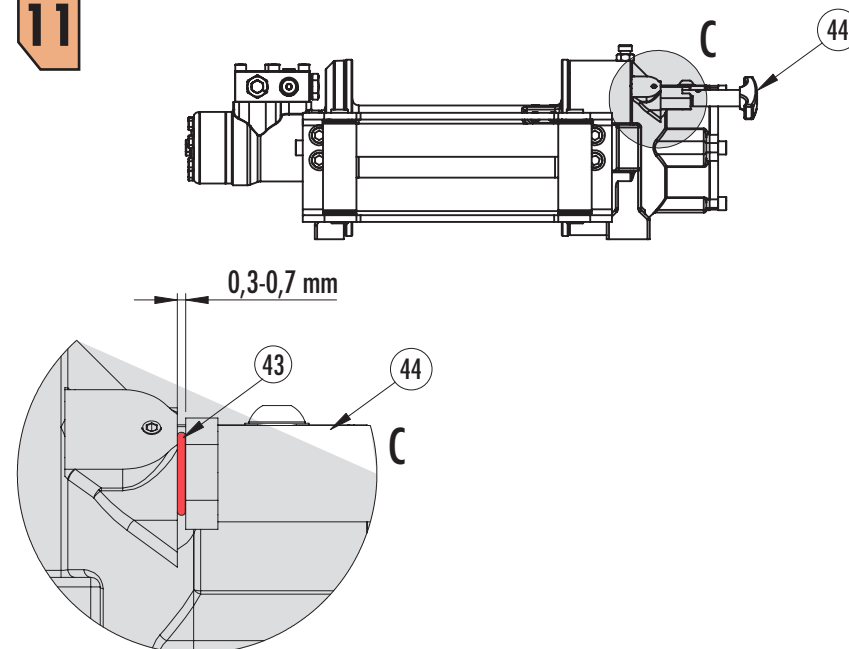

TIGHTENING

Tighten the manual clutch (Ref.44) as shown at (Pict.10-11) having care do not causing an excessive O-ring (Ref.43) flattening on gear housing, as shown at (Pict.11 view C).

12

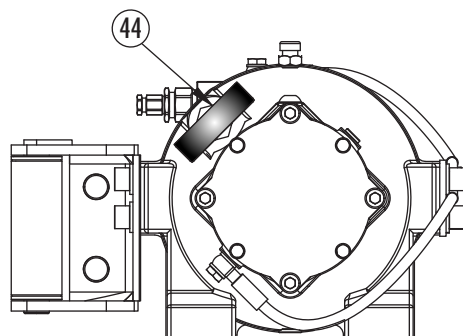

MANUAL CLUTCH HANDLE POSITIONING

After having tightened the manual clutch (Ref.44) as shown at (Pict.12), be sure the manual clutch handle being positioned as shown at (Pict.12).

13

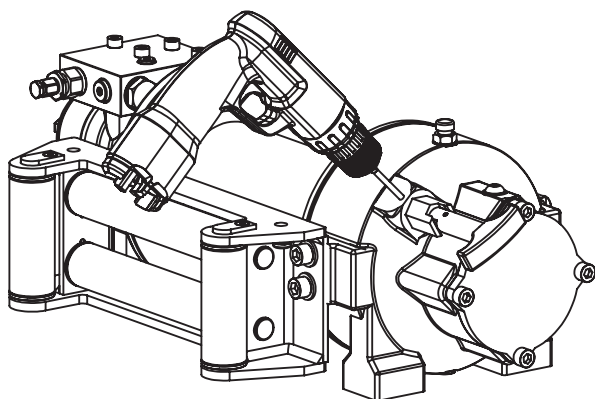

MAKE A SEAT

Before to procede to the capscrew tightening (Ref.24), make with a drill equipped with a drill bit size 5 mm a seat (depth 1 mm / 1,5 mm) as shown at (Pict.13)



ATTENTION

To assemble the manual clutch (Ref.44) without making a seat as shown at (Pict.13), would be able in a following dismantlement of the manual clutch (Ref.44) cause the irreparable damage of the gear housing thread (ref.X)

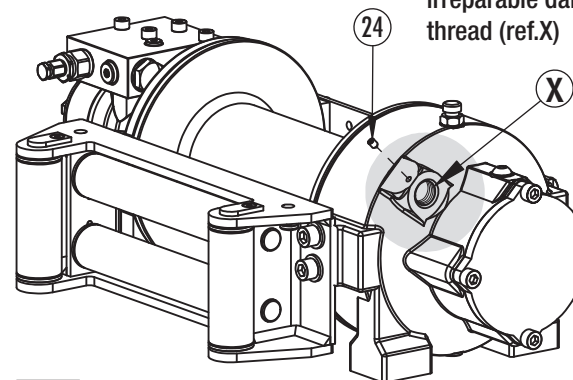

14

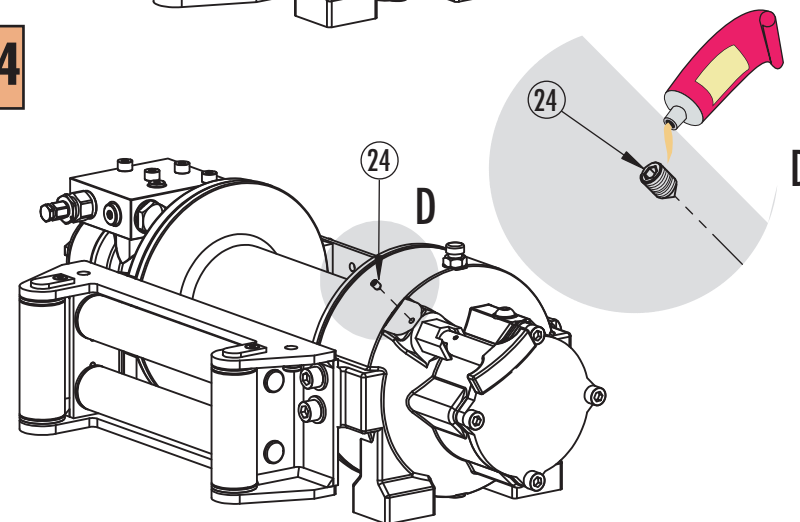

TIGHTENING

Before to procede to the capscrew tightening (Ref.24) sprinkle the capscrew thread with a sealing product as shown at (Pict.14 view D).

FINAL TEST

At the end of the operation, try to engage and disengage the winch drum.